



A check list of what you need to know before you get started on your Green Roof Project

1. Planning

All you need to know before you begin to install your green roof system:

Waterproofing layer

Is your roof watertight? What is it made of e.g., EPDM/GRP/Fibreglass? It is important to understand what can be placed onto this layer and if it needs a Protective Cover or Root Protection Foil.

N.B., we don't provide or advise on your waterproofing layer, this should be discussed with your roofer/builder.

Weight bearing capacity

A Structural Engineer/Architect or the manufacturer of your structure and roof can potentially calculate or provide this for you. This is NOT a calculation we can make for you. Please be sure that you're comfortable with your decision.

Roof pitch

It's important to know this to ensure the correct system is applied. Our systems are straightforward when added to a roof pitch between 2° and 15°, but we can supply bespoke green roof solutions for pitches outside of these when required.

Drainage

Where does the rainwater run-off go? Do you have a gutter or down pipe where it will fall? We have various products that will work with your drainage structure, ensuring rainwater is able to exit the roof.

Up-Stand

Do you have an up stand around the roof? If not, then our Roof Edge Drainage Profiles and Roof Separation Profiles can be used to create an up stand, which then holds the system in place and gives it an edge.

2. Measurements

You will need the following measurements:

Overall m² dimensions

This is the full area of the roof to be greened.

Linear meters

These are the measurements of each side of the roof, see example below. It's important to know this to be able to work out how much product is required around these sides, such as Gravel for your borders and Roof Edge Profiles or Separation Profiles.

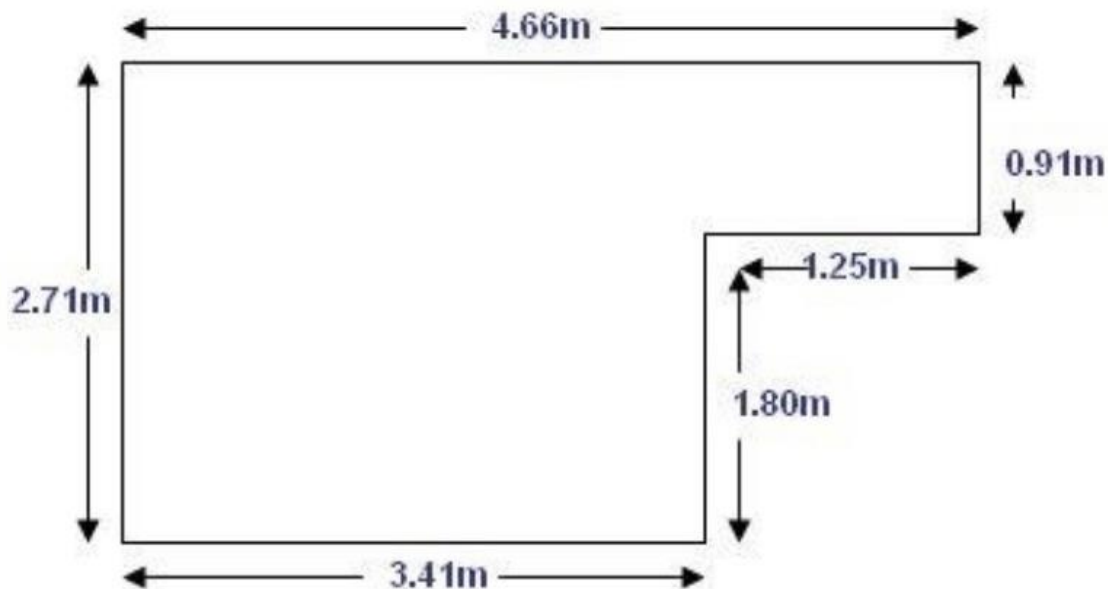

Lanterns/Roof/Sky lights

Measurements of these are required to work out the Gravel border amounts and also to deduct this measurement from the overall dimensions of the surface area.

Fire Breaks

Measurements of any sides adjoining the wall of the house / building are crucial as this area/side must have a 500mm width of Gravel border which acts as a fire break.



3. Drainage

What is the drainage system? Guttering, down pipes or something else?

Will the drainage area require a Leaf Guard or Wire Bulb Grille to stop the area becoming blocked?

Does the area require a Gravel border around it to ensure sedum doesn't grow into/over it?

4. Access

How is the roof accessed?

Which system will be best for the situation? Sedum Trays, Lightweight Modules or Sedum Blankets and rolls system.

Can the roof be accessed for twice yearly maintenance and watering during extreme heat events?

5. Delivery

Pallets are used and delivered kerbside, so you need to consider how you will move your green roof system onto your roof.

Do you have someone to help or access to a forklift?

6. Installation

Can you install the green roof system yourself?

We have installation videos for each of our systems to give you a good idea of what is involved.

Trays / Modules can be easier for DIY enthusiasts, but they are a little more costly.



Consider your roof's accessibility and logistics

How will you get the system up on your roof and then how will you apply it? Do you need another pair of hands to help?

Many roofers, builders and landscapers are getting involved in green roof installations now, so if you're not confident in doing it yourself, you should be able to find someone local to help you.

7. Maintenance

Although sedum is hardy and requires little maintenance, it still requires weeding and a sedum conditioner boost around April/May and September/October each year.

In extreme heat events i.e., continuous high temperatures with no rain for 2-4 weeks, watering is required, sometimes daily.

Wildflower and more biodiverse vegetation green roof systems require much more maintenance including mowing 1-2 times per year.

We hope this list is useful, and although it doesn't cover every question and eventuality, it's a good starting point. If you would like any further help, please contact us:

info@thegreenroofcompany.co.uk or 0161 445 0001